

ACCESSORIES

QUICKCLICK

Quick change ends and adjust for any situation.



PHONE HOLDER

201545

Adjusts to most phones/cases. For devices 2.25" to 4" wide.



TABLET HOLDER

201541

Adjustable tablet holder scales to hold nearly all tablets.



SPRING CLAMP

201511

Approximately 6" in length and has a 2" opening with heavy-duty tips.



DESKTOP BASE

201531

Weighted base great for desks, tables, or other flat surfaces.



ADJUSTABLE CLAMP

201513

This versatile clamp mounts to flat surfaces or round tubes. Jaw opens to 2".



FREQUENT QUESTIONS

FLEXIBLE STEEL

What's the difference between the Pro Arm and a Medium Arm?

Pro Arms can handle both mid-weight applications (between 1 and 4 pounds) like tablets and e-readers, as well as lightweight applications for a fixed length (ie. smartphones, small cameras). **Medium Arms** are ideal for lightweight applications, holding up to 1 pound comfortably.

With both variations of Flexible Steel, remember: the shorter the arm, the more effective the mount configuration will be.

Does Flexible Steel need special cleaning?

Don't stress! Cleaning is easy: just wipe down the vinyl cover with a towel and mild detergent.

MODULAR METAL

What situations should I use the Modular Metal Arm in?

This arm can be used for all kinds of activities—mounting on a bedside, in cars, on bikes, or even for watersports. The sharp angles can be manipulated by adjusting the arm's Joint-Clamps.

Depending on the configuration, it can support up to 3 pounds; best for use with mid-weight devices such as tablets and AAC devices.

MODULAR PLASTIC

Which is better: a long or short arm?

A general rule of thumb is to keep the arm as short as your application will allow. The shorter the arm, the less likely it will be to sag. If you have heavier objects to support, you might want to add a second arm to distribute the weight.

Longer arm lengths usually aren't recommended for impact-inducive activities. If there's a use that might cause excessive rattle, don't configure an arm more than 6" in max length.

I'm having trouble putting this together – any suggestions?

You can assemble the hose by hand with proper leverage. If you're having trouble with this, we also have ModularHose Assembly Pliers (sold separately) that make this easier. Also, don't be afraid to contact us; we're happy to help!

How should I take care of my setup?

Components are durable and can endure rigors of many uses. If you find any of the sections in your arm beginning to fatigue, pop apart the arm to remove at-fault components, replace, then reassemble.

Clean by wiping each joint with a dry cloth to remove residual oils and other residue. Rotate joints while wiping to ensure a thorough cleaning.



CARE & USE GUIDE



featuring

QUICKCLICK



HOW TO ORDER

You can visit our website and browse the catalog of MOGO products and order online. You can also submit your order by phone or email.

LEARNING CENTER

Check out the Learning Center on our website for a look at sample-use cases, detailed introductions to using products, and other assistive solutions.

INTRODUCTION

MOGO is adaptively designed to offer a variety of unique and flexible options for mounting. Our selection of arms grant the ability to configure for your exact needs and the integrated **QuickClick** feature allows you to swap out accessories quickly.

With the introduction of **QuickClick** as the standard attachment feature on all MOGO products, our accessory ends work universally across any of the three MOGO arm options.

MODULAR PLASTIC

A plastic ball-in-socket arm segment for lightweight uses. Easily adjustable with many points of articulation.



ARM OPTIONS

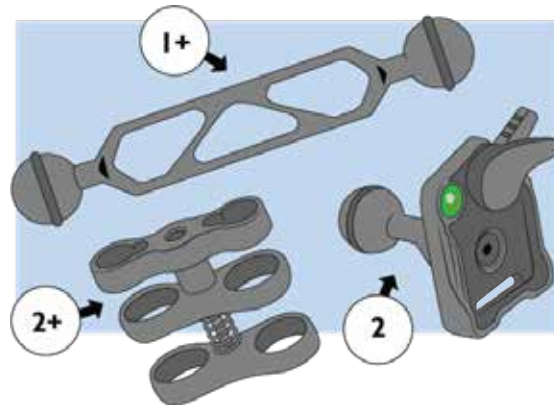

- !** The MOGO Modular Metal arm is comprised of 3 primary components:
- Double Ball Arm segments
 - Joint-Clamp connectors
 - Ball-to-QuickClick ends

FLEXIBLE STEEL

Our gooseneck-style arms that come in fixed lengths, ideal for medium weight applications. There are two strengths available: **Medium** (best for light weight uses), and **Pro** arms (heavier uses).

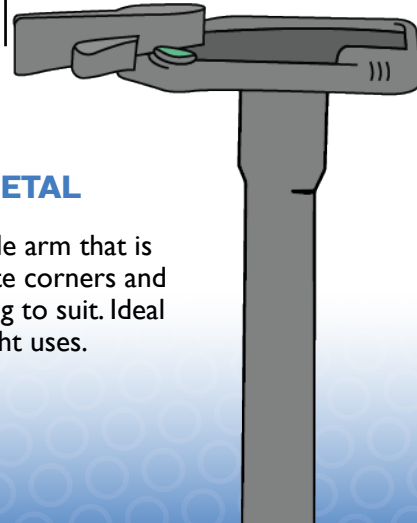

MODULAR METAL

Ball-and-joint style arm that is able to manipulate corners and lock in positioning to suit. Ideal for medium weight uses.

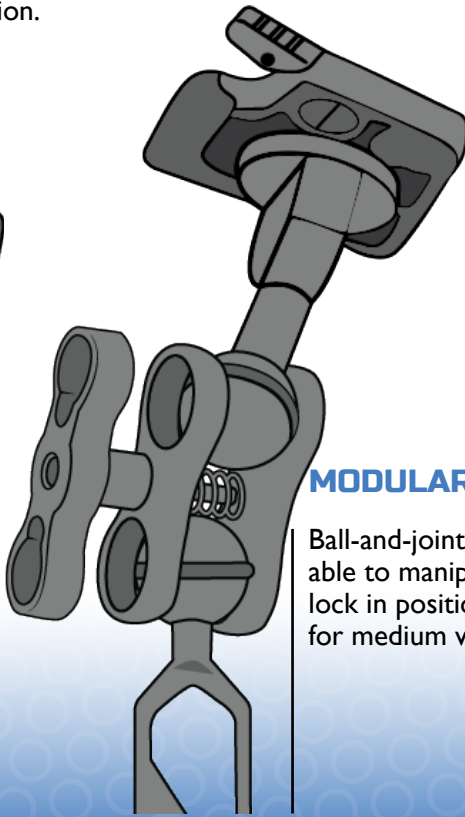

ASSEMBLY GUIDE

MODULAR METAL

You can add more arm segments in varying sizes. One additional Joint-Clamp connector per arm segment is required, to add to existing components.

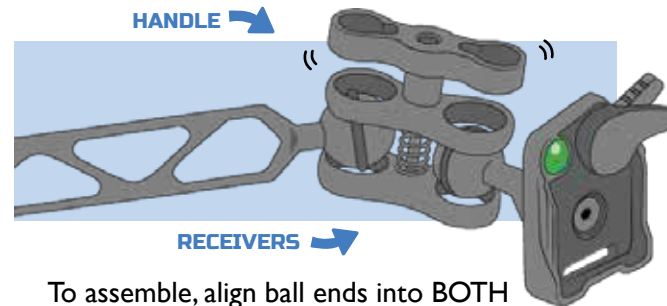

To assemble, align ball ends into BOTH Joint-Clamp receivers and tighten the handle. Be careful not to overtighten Joint-Clamps during the initial assembly.

Once components are assembled, adjust as needed and firmly tighten the handle to lock in the arm positioning. To make further adjustments, loosen the Joint-Clamp slightly to reposition and tighten firmly to reset the arm.

- !** Warning: Both Joint-Clamp receivers must house a ball before tightening. **Attempting assembly with only one ball in position can result in product failure.**

MODULAR PLASTIC

MOGO Modular Plastic arms utilize the same bead elements as the ModularHose mounting system. To subtract length, bend the arm sharply to leverage apart. Add length by aligning additional beads/segments and firmly forcing the ball into the socket.

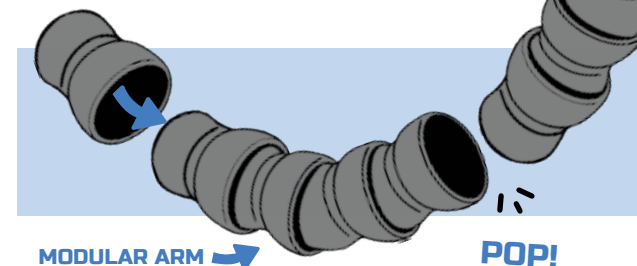

FLEXIBLE STEEL

MOGO Flexible Steel is a fixed length mounting arm and requires no initial assembly. Simply click in a QuickClick accessory to finalize setup.

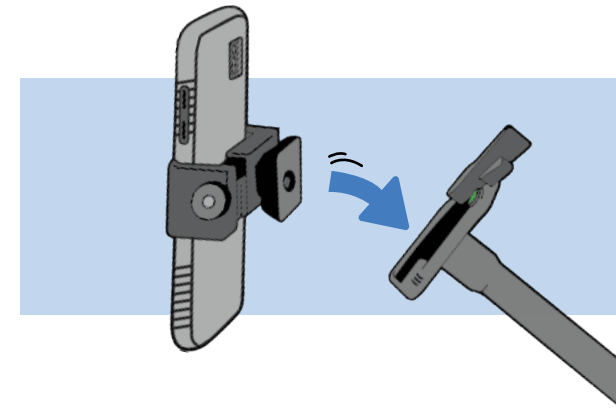

ACCESSORIES

All MOGO mounting arms are standard with the **QuickClick** feature. QuickClick offers the ability to effortlessly switch between arms and accessories.

Mounts will slide or pop right into place, allowing accessibility to all kinds of devices. Clamps, bases, and more - QuickClick allows you to accessorize quickly without the hassle of reassembly.

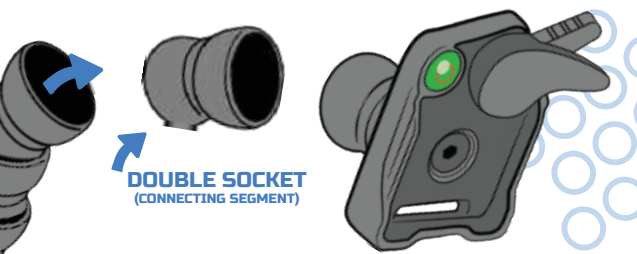

- !** ModularHose or **Modular Plastic** arms utilize a mounting bead that is joined by a fixed fitting— make sure your QuickClick mount is made for this!

[SEE FREQUENT QUESTIONS ABOUT MOGO MOUNTS](#)

HAVING TROUBLE...? NO WORRIES!

EMAIL: INFO@MOGOMOUNTS.COM